

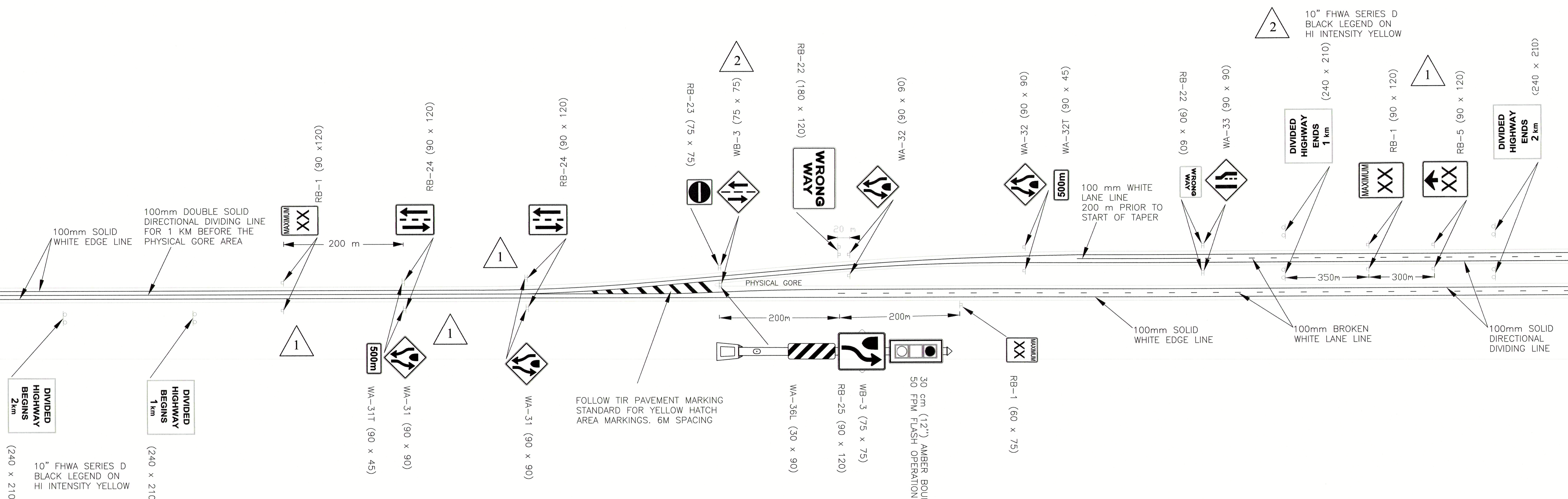

TRAFFIC ENTERING DIVIDED HIGHWAY ON STRAIGHT ALIGNMENT



FOLLOW TIR PAVEMENT MARKING STANDARD FOR YELLOW HATCH AREA MARKINGS. 6M SPACING

- NOTES
1. OTHER SIGNS NOT SHOWN ON THIS PLAN, MAY BE REQUIRED FOR SITE SPECIFIC CONDITIONS. THESE SIGNS MUST BE APPROVED BY THE TRAFFIC AUTHORITY.
  2. HIGHWAY MARKINGS WILL FOLLOW THIS PLAN AND TIR PAVEMENT MARKING STANDARDS.
  3. GUIDE, SERVICE, TOURISM, BUSINESS LOGO, AND COMMUNITY IDENTITY SIGNS ARE NOT TO BE PLACED WITHIN 1KM OF THE PHYSICAL GORE IN EACH DIRECTION WHENEVER POSSIBLE.
  4. MEDIAN FLASHING LIGHT SHALL BE LOCATED IN THE PHYSICAL GORE WITH A MINIMUM OF 3M OFFSET TO DIRECTIONAL DIVIDING LINES (CENTER LINES).
  5. ALL DIMENSIONS ARE IN cm UNLESS OTHERWISE NOTED.

Designed by:	
Surveyed by:	
Drawn by:	PH
Checked by:	
Approved by:	

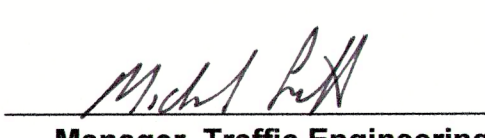
  
 Provincial Traffic Authority  
  
 Manager, Traffic Engineering Services  
 Date: Feb 18/16  
 Date: Feb 18/16

MK.	DATE	REVISION
2	Jan 2016	Double Post WB-3, Highway Begins and Ends sign details note
1	Sept 2015	Double Post RB-1 RB-24 WA-31 and RB-1 to RB-5 spacing increase



Scale:	Sept 2015
Date:	December 2013
File No.:	S-2013-313-1
Sheet No.:	1 of 2

SIGNS AND MARKINGS

STRAIGHT TRANSITION FROM TWO LANE TWO WAY TO FOUR LANE DIVIDED 100 SERIES HIGHWAYS